



ALLNET

ALL-HS02530

300Mbit Hotspot in a Printer

Wireless Subscriber Gateway with built-in thermal printer to generate user's account for Internet access and is perfect for small venue owners

- *All-In-One Instant Hotspot Gateway with built-in Thermal Printer*
- *Compatible with IEEE802.11n/b/g , Wireless 2T2R 2.4GHz with 300Mbps high speed network*
- *Support up to 30 simultaneous devices and up to 256 local accounts*

With BYOD trend today, Wi-Fi service isn't only a side benefit of your business, it also attracts people to come over. Most people need Wi-Fi access for their works, researches and communications. Therefore, the ALL-HS02530 offers you a robust and secure hotspot solution which is just perfect for the mini size venues such as café/airport, lounge/store or shop and provides customizable billing profiles.

While you focus on growing and managing your core business, the ALL-HS02530 can help to promote your products, services and satisfy your customers. With its user friendly design, venues owners can easily train their staffs to operate the gateway and print out the account ticket to access Internet for their customers.

Art. Nr. 104128

Note: Product specification is subject to change without notice

www.allnet.de



Support WPA / WPA2 Encryption

Administration access Control, Layer 2 Isolation and SSL login page to enhance security

AAA Control and Billing Support

Support network access control service including Authentication, Authorization and Accounting (AAA) for internet subscribers and 10 billing profiles

Support Rich Networking Functions

Transparent HTTP proxy, and various WAN connections

VPN PASS Through

Run your VPN or Secure tunnelling client software to connect to your company's VPN server

IP Plug and Play Internet Access

Zero configuration Internet access! Connect your office PC, laptop and handheld devices to the network without human intervention. It will automatically configure itself for the network

The ALL-HS02530 can be used as a standalone authentication gateway to monitor and control Internet access while guests/visitors are visiting. The features of ALL-HS02530 support web-based authentication and management tool and marketing cooperation such as walled gardens, an internal portal page, and external portal page redirection. It also offers bandwidth and billing management for users who need the differential QoS.

Traditionally, the small venues provide guests public access to Internet with one common username/password. It is insecure and easy to get identity hijacked. The venue owner will take lots of efforts to provide the secure Internet access for guests. They have to pre-build user's accounts and print them out. With advantage of the ALL-HS02530 patented Account Generator, you just press a button to print the Internet access ticket with private username/password in few seconds.

We also design a login page for venues to key-in guests/visitors identity to fit the laws. According to the law, it requires venue owners to provide the guest's Internet usage records for tracking. Thus the ALL-HS02530 provides a Real-time session information and the remote site administrator could monitor the real time usage status via Session information page.

The ALL-HS02530 is one of unique innovation from Handlink, it's more than a simple Wi-Fi hotspot device; it's also equipped with IP Plug and Play technology so there's no need for end-users to change any settings in the their devices. It's fast, easy and trouble free to access Internet.



SOFTWARE	
Network Specification	IEEE802.3 10BaseT Ethernet IEEE802.3u 100BaseTX Fast Ethernet IEEE802.11n/b/g
Wireless	IEEE802.11n 4 ESSID
Frequency Band	2.4 GHz frequency band
Wireless Operation Range	TBD
Concurrent Devices	30
Wireless Data Rate	Up to 300Mbps with auto fall back with 802.11b/g
Networking	IP Plug and Play (iPnP) HTTP Proxy Support SMTP Server Redirection DHCP Server (RFC 2131) / DHCP Relay (RFC 1542) Static IP / DHCP / PPPoE / PPTP WAN Client NAT (RFC 1631); IP Routing; NTP Support Local Account:256 Max Session Number up to 16384
Encryption	WEP 64/128bit, WPA-PSK TKIP, WPA2-PSK (AES) WPA / WPA2 Mix mode
Authentication	Built in Authentication Radius Authentication / Accounting Web-based Authentication/ Account Manager / Authorization User Agreement
Billing	Accounting without PC operating Credit Card Support 10 Customizable Billing Profile Prepaid Billing Mechanism Time-Base Billing (by minute, hour, day and week) Account Log Max. 1000
Security and Firewall	Layer 2 Isolation SSL Login Page/SSL Administration VPN Pass through (IPSec/PPTP/L2TP) Customize SSL Certificate Pass through Destination IP/URL Pass through Source IP/MAC Restricted Destination Filtering IP/URL VPN PPTP Client
Management	Remote Browser-based Configuration and management Authorized remote management (Access Control List) Firmware Upgrade (RFC 1350) via HTTP/ TFTP Scheduled Firmware Upgrade Dynamic DNS Real-time Current User List / DHCP Clients List / Session List / Account List Syslog Bandwidth / Session control per user Session Trace Secure Remote via PPTP VPN SNMP V1/ V2c (Read Only and OID 500) Ping Command SSL Certificate upload
Marketing Cooperation	Advertisement URL link Walled garden Customize Login Page, Logo, Information Windows, Account Print out, Credit Card, UserAgreement Portal Page



HARDWARE	
Power Requirement	External power adaptor Input: 100-240 VAC, 50/60 Hz Output: 12V, 1.5Amp
Input / Output	One RJ-45 connector for 10/100BaseTX WAN/WLAN Ethernet port with Auto Cross-over One Micro USB Connector (F) for USB Key Pad /LTE USB Modem / USB to Ethernet Reset button WAN Yellow light : a port has established a valid 10/100Mbps network connection. Yellow Blinking:10/100Mbps traffic is traversing the port. UPLINK Green light : The Wireless Subscriber Gateway has established a valid wireless connection. Green light: The Wireless connection is active.
Dimension	(L): 109 mm / (W): 155 mm / (H): 90 mm Weight: about 340g (net)
Printer Tray	Push button: push to open printer cover Tear bar: cuts receipt paper Button A: flashing when printer cover is opened Paper roll housing: put paper roll here
Paper Roll Specification	(W): 58 (+1/-1) mm / (L): 50meters (max) / Thickness: 65um Outside diameter: 63(+2/-2) mm Inside diameter: 12(+0.5/-0.5) mm Weight: 120g
Environmental Conditions	Operating temperature: 0 °C to 50°C Storage temperature: -10 °C to 60°C Humidity: 10% ~ 90% non-condensing 10% ~ 80% condensing
Certification	CE

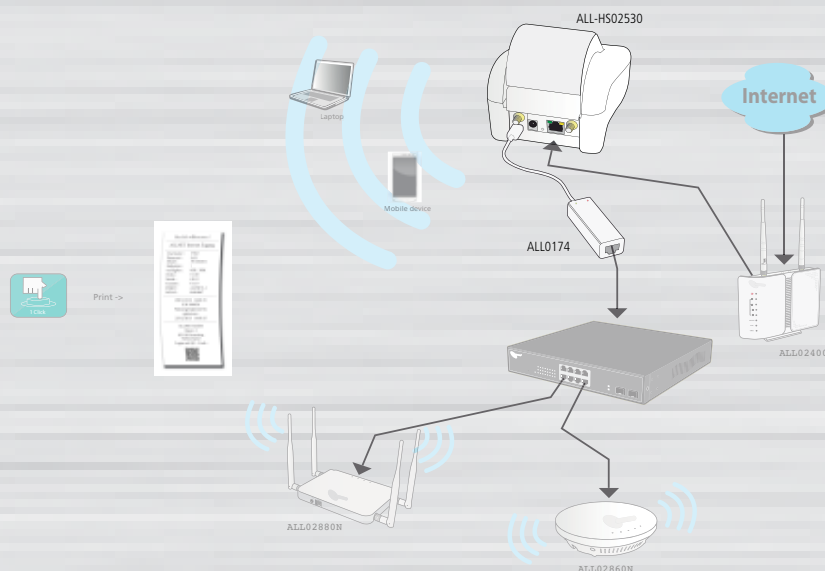



ALL0174

**ALLNET USB Micro adapter
USB 2.0 Fast Ethernet Micro-USB LAN adapter**

LAN-Extension kit

Art.-Nr. 107812



Additional paper

Paper roll, thermal paper, 50m

Art.-Nr. 108937

„Access points to extend the range



ALL02880ND

2,4GHz & 5GHz concurrent, 300Mbit PoE access point with external antennas

Art.-Nr. 104001



ALL02860ND

2,4GHz & 5GHz concurrent - 300Mbit PoE access point with external antennas

Art.-Nr. 104002



ALL02850N

2,4GHz 300Mbit PoE access point

Art.-Nr. 104003